

Application for Zoning Permit – Applicant MUST be Legal Property Owner!

Name: \_\_\_\_\_

Telephone: \_\_\_\_\_ Date of Application: \_\_\_\_\_

Email (option): \_\_\_\_\_

Owner's Mailing Address: \_\_\_\_\_

\_\_\_\_\_

Job Site Address: \_\_\_\_\_

\_\_\_\_\_

Legal Description: Lot \_\_\_\_\_ Block \_\_\_\_\_ Addition: \_\_\_\_\_

or Tax Parcel Number: \_\_\_\_\_ Is this a corner lot? Y N

Contractor: \_\_\_\_\_

License #: \_\_\_\_\_ Contractor Telephone Number: \_\_\_\_\_

Project Description: \_\_\_\_\_

\_\_\_\_\_

\_\_\_\_\_

Proposed Use: Residential Commercial

If doing Construction:

Front or Width in feet: \_\_\_\_\_ Side or Length in feet: \_\_\_\_\_

Height in feet: \_\_\_\_\_ Number of Stories: \_\_\_\_\_

Type of foundation: \_\_\_\_\_

Total Cost of Project (including materials & labor): \_\_\_\_\_

**NO CONSTRUCTION SHALL BEGIN UNTIL THIS APPLICATION HAS BEEN APPROVED BY THE CODE  
ADMINSTRATOR OR BUILDING OFFICIAL OF THE CITY OF LAKE PARK!**

**Work must be completed within 1 year of application approval. If work is not completed, a  
new zoning permit will be needed.**

**CONTINUED ON OPPOSITE SIDE!**



Application for Zoning Permit – Applicant MUST be Legal Property Owner!

**SITE PLAN DESIGN**

Sketch the proposed project on the graph below. Include the following items:

- Lot Size (dimensions)
- Dimensions of the Proposed Project
- Distance from property line (setbacks) on ALL sides.

A large grid for sketching the site plan design. The grid consists of 20 columns and 20 rows of squares, providing a space for drawing the lot, project dimensions, and setbacks.

I hereby certify that the facts stated in this application are true and correct to the best of my knowledge:

Approved

Denied

\_\_\_\_\_  
Signature of Applicant

Date: \_\_\_\_\_

\_\_\_\_\_  
City Official

Date: \_\_\_\_\_

### SAMPLE Site Plan Design Sketch

(As required on application)

The City of Lake Park requires the front setback to be inspected by city staff prior to installation of footings.

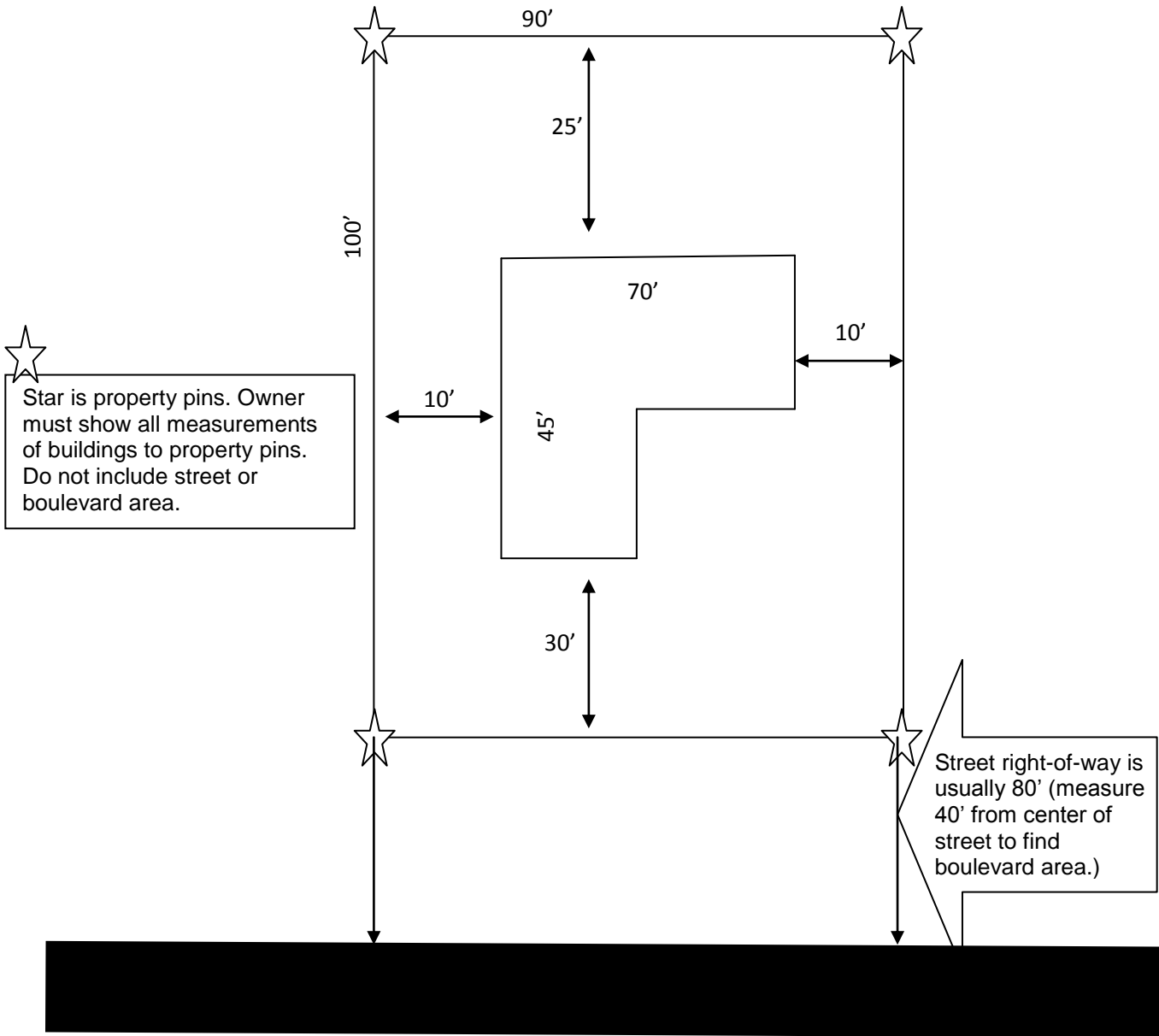

The property owner must contact the City Clerk's office once the structure has been staked out. City staff will measure to ensure that setbacks are adequate. THE CITY OF LAKE PARK ASSUMES NO RESPONSIBILITY OR LIABILITY FOR THE ACCURACY OF ANY PROPERTY PINS.